

47 X 23

47 X 23

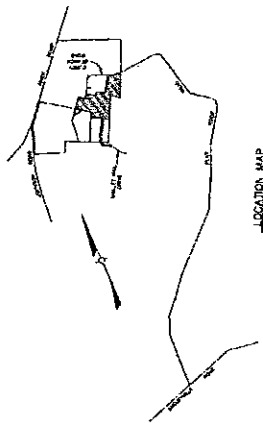

- NOTES:**
- 1) THIS PLAN IS THE PROPERTY OF THE ENGINEER AND IS NOT TO BE REPRODUCED OR COPIED IN ANY MANNER WITHOUT HIS WRITTEN PERMISSION.
 - 2) THE ENGINEER HAS CONDUCTED VISUAL SURVEYS AND PHOTOGRAPHS OF THE SITE AND HAS FOUND NO OBVIOUS OBSTRUCTIONS TO THE PROPOSED DEVELOPMENT.
 - 3) THE PLAN IS SUBJECT TO THE REVIEW AND APPROVAL OF THE LOCAL GOVERNMENT AND THE STATE DEPARTMENT OF TRANSPORTATION.
 - 4) THE ENGINEER HAS CONDUCTED VISUAL SURVEYS AND PHOTOGRAPHS OF THE SITE AND HAS FOUND NO OBVIOUS OBSTRUCTIONS TO THE PROPOSED DEVELOPMENT.
 - 5) THE ENGINEER HAS CONDUCTED VISUAL SURVEYS AND PHOTOGRAPHS OF THE SITE AND HAS FOUND NO OBVIOUS OBSTRUCTIONS TO THE PROPOSED DEVELOPMENT.
 - 6) THE ENGINEER HAS CONDUCTED VISUAL SURVEYS AND PHOTOGRAPHS OF THE SITE AND HAS FOUND NO OBVIOUS OBSTRUCTIONS TO THE PROPOSED DEVELOPMENT.
 - 7) THE ENGINEER HAS CONDUCTED VISUAL SURVEYS AND PHOTOGRAPHS OF THE SITE AND HAS FOUND NO OBVIOUS OBSTRUCTIONS TO THE PROPOSED DEVELOPMENT.
 - 8) THE ENGINEER HAS CONDUCTED VISUAL SURVEYS AND PHOTOGRAPHS OF THE SITE AND HAS FOUND NO OBVIOUS OBSTRUCTIONS TO THE PROPOSED DEVELOPMENT.
 - 9) THE ENGINEER HAS CONDUCTED VISUAL SURVEYS AND PHOTOGRAPHS OF THE SITE AND HAS FOUND NO OBVIOUS OBSTRUCTIONS TO THE PROPOSED DEVELOPMENT.
 - 10) THE ENGINEER HAS CONDUCTED VISUAL SURVEYS AND PHOTOGRAPHS OF THE SITE AND HAS FOUND NO OBVIOUS OBSTRUCTIONS TO THE PROPOSED DEVELOPMENT.

PROPERTY OF DEVELOPER AND ENGINEER

OWNER: POLO JOINT VENTURE, LLC

ENGINEER: SABAK, WILSON & LINGCO INC.

DATE: JANUARY 2001

SCALE: 1" = 100'

SECTION 14

OWNER & DEVELOPER: POLO JOINT VENTURE, LLC

DEED BOOK 7481, PAGE 696

TAX BLOCK RECORDS 6, 34-1 & 54-2

10600 TIMBERWOOD CIRCLE, SUITE 4

LOUISVILLE, KENTUCKY 40223

JANUARY 2001

SCALE: 1" = 100'

SABAK, WILSON & LINGCO INC.

ENGINEERS, LANDSCAPE ARCHITECTS & PLANNERS

315 WEST MARKET

LOUISVILLE, KENTUCKY

LOT	AREA (SQ. FT.)	AREA (AC.)
1	10,000	0.23
2	10,000	0.23
3	10,000	0.23
4	10,000	0.23
5	10,000	0.23
6	10,000	0.23
7	10,000	0.23
8	10,000	0.23
9	10,000	0.23
10	10,000	0.23
11	10,000	0.23
12	10,000	0.23
13	10,000	0.23
14	10,000	0.23
15	10,000	0.23
16	10,000	0.23
17	10,000	0.23
18	10,000	0.23
19	10,000	0.23
20	10,000	0.23
21	10,000	0.23
22	10,000	0.23
23	10,000	0.23
24	10,000	0.23
25	10,000	0.23
26	10,000	0.23
27	10,000	0.23
28	10,000	0.23
29	10,000	0.23
30	10,000	0.23
31	10,000	0.23
32	10,000	0.23
33	10,000	0.23
34	10,000	0.23
35	10,000	0.23
36	10,000	0.23
37	10,000	0.23
38	10,000	0.23
39	10,000	0.23
40	10,000	0.23
41	10,000	0.23
42	10,000	0.23
43	10,000	0.23
44	10,000	0.23
45	10,000	0.23
46	10,000	0.23
47	10,000	0.23
48	10,000	0.23
49	10,000	0.23
50	10,000	0.23
51	10,000	0.23
52	10,000	0.23
53	10,000	0.23
54	10,000	0.23
55	10,000	0.23
56	10,000	0.23
57	10,000	0.23
58	10,000	0.23
59	10,000	0.23
60	10,000	0.23
61	10,000	0.23
62	10,000	0.23
63	10,000	0.23
64	10,000	0.23
65	10,000	0.23
66	10,000	0.23
67	10,000	0.23
68	10,000	0.23
69	10,000	0.23
70	10,000	0.23
71	10,000	0.23
72	10,000	0.23
73	10,000	0.23
74	10,000	0.23
75	10,000	0.23
76	10,000	0.23
77	10,000	0.23
78	10,000	0.23
79	10,000	0.23
80	10,000	0.23
81	10,000	0.23
82	10,000	0.23
83	10,000	0.23
84	10,000	0.23
85	10,000	0.23
86	10,000	0.23
87	10,000	0.23
88	10,000	0.23
89	10,000	0.23
90	10,000	0.23
91	10,000	0.23
92	10,000	0.23
93	10,000	0.23
94	10,000	0.23
95	10,000	0.23
96	10,000	0.23
97	10,000	0.23
98	10,000	0.23
99	10,000	0.23
100	10,000	0.23

PROPERTY OF DEVELOPER AND ENGINEER

OWNER: POLO JOINT VENTURE, LLC

ENGINEER: SABAK, WILSON & LINGCO INC.

DATE: JANUARY 2001

SCALE: 1" = 100'

SECTION 14

OWNER & DEVELOPER: POLO JOINT VENTURE, LLC

DEED BOOK 7481, PAGE 696

TAX BLOCK RECORDS 6, 34-1 & 54-2

10600 TIMBERWOOD CIRCLE, SUITE 4

LOUISVILLE, KENTUCKY 40223

JANUARY 2001

SCALE: 1" = 100'

SABAK, WILSON & LINGCO INC.

ENGINEERS, LANDSCAPE ARCHITECTS & PLANNERS

315 WEST MARKET

LOUISVILLE, KENTUCKY

POLO FIELDS

SECTION 14

OWNER & DEVELOPER: POLO JOINT VENTURE, LLC

DEED BOOK 7481, PAGE 696

TAX BLOCK RECORDS 6, 34-1 & 54-2

10600 TIMBERWOOD CIRCLE, SUITE 4

LOUISVILLE, KENTUCKY 40223

JANUARY 2001

SCALE: 1" = 100'

SABAK, WILSON & LINGCO INC.

ENGINEERS, LANDSCAPE ARCHITECTS & PLANNERS

315 WEST MARKET

LOUISVILLE, KENTUCKY

TOTAL AREA IN SITE: 33,989 ACRES

TOTAL NUMBER OF BUILDING SITES: 33

NOTES SET 5/8" IRON PIN W/CAP

STAMPED S.L. BURCH, L.S. 3022

UNLESS OTHERWISE NOTED.

PROPERTY OF DEVELOPER AND ENGINEER

OWNER: POLO JOINT VENTURE, LLC

ENGINEER: SABAK, WILSON & LINGCO INC.

DATE: JANUARY 2001

SCALE: 1" = 100'

SECTION 14

OWNER & DEVELOPER: POLO JOINT VENTURE, LLC

DEED BOOK 7481, PAGE 696

TAX BLOCK RECORDS 6, 34-1 & 54-2

10600 TIMBERWOOD CIRCLE, SUITE 4

LOUISVILLE, KENTUCKY 40223

JANUARY 2001

SCALE: 1" = 100'

SABAK, WILSON & LINGCO INC.

ENGINEERS, LANDSCAPE ARCHITECTS & PLANNERS

315 WEST MARKET

LOUISVILLE, KENTUCKY

PROPERTY OF DEVELOPER AND ENGINEER

OWNER: POLO JOINT VENTURE, LLC

ENGINEER: SABAK, WILSON & LINGCO INC.

DATE: JANUARY 2001

SCALE: 1" = 100'

SECTION 14

OWNER & DEVELOPER: POLO JOINT VENTURE, LLC

DEED BOOK 7481, PAGE 696

TAX BLOCK RECORDS 6, 34-1 & 54-2

10600 TIMBERWOOD CIRCLE, SUITE 4

LOUISVILLE, KENTUCKY 40223

JANUARY 2001

SCALE: 1" = 100'

SABAK, WILSON & LINGCO INC.

ENGINEERS, LANDSCAPE ARCHITECTS & PLANNERS

315 WEST MARKET

LOUISVILLE, KENTUCKY

PROPERTY OF DEVELOPER AND ENGINEER

OWNER: POLO JOINT VENTURE, LLC

ENGINEER: SABAK, WILSON & LINGCO INC.

DATE: JANUARY 2001

SCALE: 1" = 100'

SECTION 14

OWNER & DEVELOPER: POLO JOINT VENTURE, LLC

DEED BOOK 7481, PAGE 696

TAX BLOCK RECORDS 6, 34-1 & 54-2

10600 TIMBERWOOD CIRCLE, SUITE 4

LOUISVILLE, KENTUCKY 40223

JANUARY 2001

SCALE: 1" = 100'

SABAK, WILSON & LINGCO INC.

ENGINEERS, LANDSCAPE ARCHITECTS & PLANNERS

315 WEST MARKET

LOUISVILLE, KENTUCKY